



LINDSAY McRAE

exp[®] UK

@ lindsay.mcrae@exp.uk.com

🌐 lindsaymcrae.exp.uk.com

☎ 07971 796 225

Stratford Way, Hemel Hempstead, HP3 9BA

Guide Price £225,000

🛏 1 🚿 1 🚿 1



Ref: BM:0526. An upgraded GROUND FLOOR FLAT with stunning REFITTED ULTRA MODERN SHOWER ROOM & close to Hardings Moor PARK! An unusual & rarely available ONE BEDROOM home with Gas Fired Heating to Radiators, Double Glazed Windows & Bay window to the Lounge, plus a modern 'Vaillant' EcoTEC 24 combi gas boiler . Enjoy exploring the neighbouring park & Grand Union canal or perhaps try out one of Hemel Hempstead's many restaurants. Perfectly located in this sought-after location in Hemel Hempstead, a pleasant walk from the centre of old BOXMOOR village, or Apsley Lock MARINA with its restaurants. The perfect spot for busy commuters hankering after Green space, but with a only a 10 minute walk to Hemel Hempstead TRAIN STATION (25 mins into London EUSTON) or 5-minute walk into the town centre. The Grand Union canal offers walks into the nearby countryside, heading South towards the village of Kings Langley or towards Bourne End & the market town of Berkhamsted. This flat benefits from NO SALES CHAIN plus extremely reasonable SERVICE CHARGES of £600 PA. Book your VIEWING NOW.



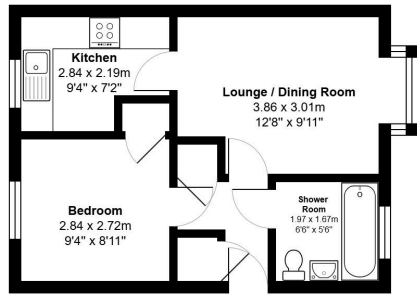

Total Area: 35.4 m² ... 381 ft²
 All measurements are approximate and for display purposes only

- Reference: BM 0526
- Stunning Refitted Shower Room
- Fitted Kitchen with Eye & Base Level Units
- Sought after BOXMOOR Location
- Vaillant EcoTEC 24 Combi Gas Boiler
- Lovely ONE BEDROOM APARTMENT
- Gas Fired Heating to Radiators
- Perfect Location for Commuters
- Lounge with Bay Window
- NO SALES CHAIN

